

## PILL

Apparecchio orientabile da incasso per interni realizzato in alluminio anodizzato nero con sistema di fissaggio tramite molle in acciaio. Tre ottiche secondarie (lenti) e due temperature colore disponibili. Data l'altezza ridottissima e le dimensioni contenute è ideale, oltre che per illuminazione di teche e nicchie, per l'installazione in mensole ed ovunque siano richiesti spessori ridotti.

Adjustable recessed luminaire for indoor installation. Black anodized aluminum body and steel springs fixing system. Three secondary optics (lenses) and two colour temperature available. Thanks to small height and the small dimensions it is ideal for lighting of display cases and niches, as well as for installation in shelves and everywhere it's required reduced thickness.

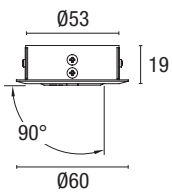



Optical Info p. 531

Power	Size	Code	Light temperature	CRI	Source	Optic	Weight	Light output	Hole size	Colour
<b>3 W</b>	Round Ø 60 mm. x h. 19 mm.	<b>RTL48101</b>	3000 K	> 80	POWER LED	10°	0,09 Kg	270 lm	Ø 56 mm	white
		<b>RTL48102</b>	3000 K	> 80	POWER LED	25°	0,09 Kg	270 lm	Ø 56 mm	white
		<b>RTL48103</b>	3000 K	> 80	POWER LED	40°	0,09 Kg	270 lm	Ø 56 mm	white
		<b>RTL48107</b>	3000 K	> 80	POWER LED	10°	0,09 Kg	270 lm	Ø 56 mm	black
		<b>RTL48108</b>	3000 K	> 80	POWER LED	25°	0,09 Kg	270 lm	Ø 56 mm	black
		<b>RTL48109</b>	3000 K	> 80	POWER LED	40°	0,09 Kg	270 lm	Ø 56 mm	black
		<b>RTL48104</b>	4000 K	> 80	POWER LED	10°	0,09 Kg	290 lm	Ø 56 mm	white
		<b>RTL48105</b>	4000 K	> 80	POWER LED	25°	0,09 Kg	290 lm	Ø 56 mm	white
		<b>RTL48106</b>	4000 K	> 80	POWER LED	40°	0,09 Kg	290 lm	Ø 56 mm	white
		<b>RTL48110</b>	4000 K	> 80	POWER LED	10°	0,09 Kg	290 lm	Ø 56 mm	black
		<b>RTL48111</b>	4000 K	> 80	POWER LED	25°	0,09 Kg	290 lm	Ø 56 mm	black
		<b>RTL48112</b>	4000 K	> 80	POWER LED	40°	0,09 Kg	290 lm	Ø 56 mm	black

700mA | 2,90 V | IP40

 Driver non incluso; circuito in serie (max 5 apparecchi)  
 Driver not included; serial circuit (max 5 fixtures)

## Alimentazioni / Feeding



L'alimentatore non passa attraverso foro di incasso dell'apparecchio. Prevedere il suo posizionamento in altro luogo

The driver does not pass through the hole of installation in the false ceiling. Consider its placement elsewhere

### on-off

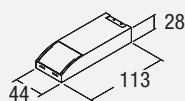

n° 1...5 pz / pcs

code	<b>DRV1005</b>
power	20 W
output voltage	2 ÷ 29V DC
voltage range	220Vac
insulation class / IP	class II / IP20

### Phase cut IGBT / TRIAC



n° 1...5 pz / pcs

code	<b>DRV1012</b>
power	32 W
output voltage	2 ÷ 47V DC
voltage range	220Vac
insulation class / IP	class II / IP20

### DALI / PUSH

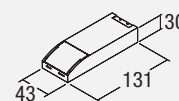

n° 2...5 pz / pcs

code	<b>DRV1030</b>
power	25 W
output voltage	9 ÷ 38V DC
voltage range	220Vac
insulation class / IP	class II / IP20